

## 55 SERIES HOSE REELS

### KITEMARKED TO BS EN 671-1:2001



Fixed Hose Reel

Hose Nozzle Interlock

#### FEATURES

- Wide range of sizes and capacities.
- Designed for fast 'hose-on' installation and maintenance.
- Automatic versions of all models, 19mm and 25mm.
- Traditional bronze axle and nylon bearings for long-term dependability.
- Supplied fully assembled, complete with roller hose guide (fixed models), stop valve (manual models) and instructions.
- Optional floor pedestals.
- Full range of cabinets.
- Offshore manual versions.
- Fixed reels can be offered with flexible inlet water pipes.

A range of fire hose reels which combine high performance and rugged constructions with compact and elegant design. All models in this standard range are available as either manual or automatic versions, with a wide variety of sizes and capacities for both 19mm (3/4") and 25mm (1") hoses.

Automatic versions feature an automatic valve mechanism manufactured from high impact acetal. Operation of the valve is outside the waterway and enclosed in a dust tight hub compartment for maximum reliability.

Manual versions can be fitted with a ball or gate valve. A hose nozzle interlock is fitted to all ball valves ensuring the water supply is turned on before running out the hose.



Surface Mounted Swinging Hose Reel

Recessed Swinging Hose Reel

55 Series swinging hose reels are available for surface or recess mounting and all feature a one-piece stainless steel swinging arm for unmatched compactness.

### Fixed Hose Reels 55FH

19mm (3/4")	25mm (1")	Dim A (mm)	Carton
15 metres		156	A
20 metres		196	A
36.5 metres*	20	236	A
45 metres*	30	276	B

Gross weight packed (without hose): 11.8kg

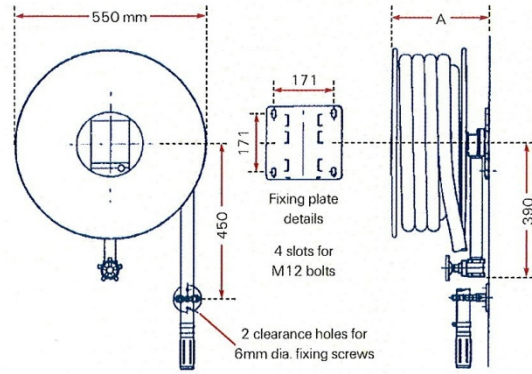

### Swinging Hose Reels 55SW

19mm (3/4")	25mm (1")	Dim A (mm)	Carton
15 metres		190	A
20 metres		230	A
36.5 metres*	20	270	A
45 metres*	30	310	B

Gross weight packed (without hose): 14.9kg

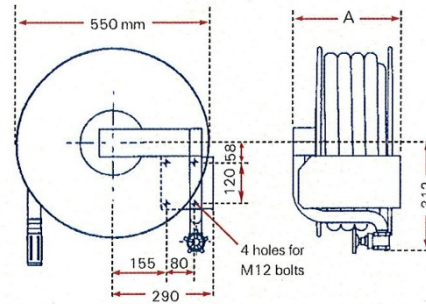

### Recess Hose Reels 55RS

19mm (3/4")	25mm (1")	Dim A (mm)	Carton
15 metres		180	A
20 metres		220	A
36.5 metres*	20	260	A
45 metres*	30	300	B

Gross weight packed (without hose): 13.6kg

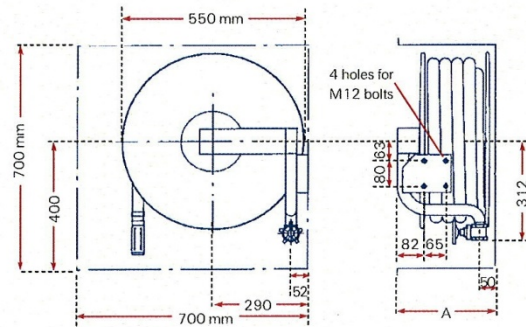

### Consignment Data

Carton type	Size cm	Max. no. per 20ft container
A	63 x 57 x 26	324
B	63 x 57 x 30	252

### Performance Data

Reel type	Hose length	Nozzle equivalent diameter	Flow at 6 bar inlet pressure to hose reel		Throw at 2 bar inlet pressure to hose reel	
			jet	spray	jet	spray
Fixed or swinging						
19mm	30m x 19mm	6mm	44 lpm	47.5 lpm	11.43m	6.30m
25mm	30m x 25mm	6mm	51 lpm	83 lpm	11.95m	6.66m

### Hose Weights

Additional weight when reels are supplied with hose tested to EN 694:

19mm (3/4") - 0.29kg/m

25mm (1") - 0.47kg/m

Package includes roller hose guide for fixed reels, stop valve for manual reels (gate valve as standard), red nylon nozzle with jet/spray action, hose clips and installation guide.

### Optional

Automatic valve	Back entry inlet
Lockshield valve	Flexible inlet on fixed models
Chrome plated brass nozzle	Ball valve on manual models